



# ***Installation Instructions***

## ***Access Manager***

***Refer to Models Included  
section for model and serial  
number information***

Original Instructions  
First Edition  
First Printing  
Part No. 1312869GT  
July 2023

# Introduction



## Observe and Obey:

- This procedure shall be completed by a person trained and qualified on the repair of this machine.
- Immediately tag and remove from service a damaged or malfunctioning machine.
- Repair any machine damage or malfunction before operating the machine.

## Before Starting Installation:

- Read, understand and obey the safety rules and operating instructions in the appropriate operator's manual.
- Be sure that all necessary tools and parts are available and ready for use.
- Read this procedure completely and adhere to the instructions. Attempting shortcuts may produce hazardous conditions.

Note: These installation instructions only apply to the Genie models and serial number ranges listed within this document.

If you have any further questions regarding these instructions or need assistance, please contact Genie Product Support at one of the following telephone numbers:

United States:	+ 800 536 1800
Canada:	+ 425 881 1800
Europe:	
UK regions	+ 311 65799800
Nordic regions	+ 311 65799801
Middle East / South Africa	+ 311 65799802
French regions	+ 311 65799803
German regions	+ 311 65799804
BNL regions	+ 311 65799805
IT / SE regions	+ 311 65799806
Spanish regions	+ 311 65799807
Australia	+ 61 7 3456 4444
Brazil	+ 0 800 031 0100
South America - other locations	+ 56 9 6431 2110
All other locations	+ 1 425 881 1800

Copyright © 2023 by Terex Corporation

First Edition: First Printing

Genie is a registered trademark of Terex South Dakota, Inc. in the U.S.A. and many other countries.

"GTH" is a trademark of Terex South Dakota, Inc.



# Introduction

## Models Included

Model	From serial number
GTH™-636	from GTH0615H-10001 to GTH0615H-10725 from GTH0615E-10000 to GTH0616E-10999 from GTH06E-11000
GTH™-844	from GTH0813-16606 to GTH0816-2156 from GTH0816H-21547 to GTH0816H-21572 from GTH0816E-10000 to GTH0816E-10699 from GTH08E-10700
GTH™-1056	from GTH1014-19341 to GTH1014-20404 from GTH1014E-10000 to GTH1016E-11799 from GTH10E-11800
GTH™-2506	from GTH2506B-211
GTH™-3007	from GTH300716M-101
GTH™-5519	from GTH55M-2375

## Tools Required:

9/32 inch wrench  
 3/32 inch hex key  
 Small flathead screwdriver  
 Flathead screwdriver  
 Wire crimper  
 Wire stripper  
 Cable tie gun or wire cutters  
 11/64 inch / 4.4 mm drill bit  
 Step drill bit, 1 inch / 25 mm  
 Drill motor  
 Mild cleaning solvent  
 Soft clean cloth

# Introduction

## Components of Kit 1312870GT

Description	Genie part number	Qty.
Cable tie, 4 inch, black	21121GT	4
Flat washer, M4, DIN125, ZAB	825357GT	4
Adjustable adhesive wire clamp	1273629GT	4
Nylock nut, M4-0.7, DIN985, 8, ZAB	1283019GT	2
Access management keypad	1296895GT	1
Access management harness	1305083GT	1
Screw, BHC, M4-0.7 x 35, 10.9, ZAB	1300832GT	2
Access manager users guide	1312446GT	1
Installation instructions	1312869GT	1

## Components of Kit 1312868GT

Description	Genie part number	Qty.
Cable tie, 4 inch, black	21121GT	8
Flat washer, M4, DIN125, ZAB	825357GT	4
Adjustable adhesive wire clamp	1273629GT	4
Nylock nut, M4-0.7, DIN985, 8, ZAB	1283019GT	2
Access management keypad	1296895GT	1
Access management harness	1296897GT	1
Screw, BHC, M4-0.7 x 35, 10.9, ZAB	1300832GT	2
Access manager users guide	1312446GT	1
Installation instructions	1312869GT	1

# Procedure

## All Models:

Note: Perform this procedure on a firm, level surface with the machine in the stowed position.

- 1 Turn the key switch to the off position and push in the red Emergency Stop button to the off position at the ground controls.
- 2 Locate and disconnect the black negative battery cable from the engine battery.

**⚠ WARNING** Electrocution/burn hazard. Contact with electrically charged circuits could result in death or serious injury. Remove all rings, watches and other jewelry.

- 3 Working inside the cab, mark the locations on the dashboard to drill the required holes.

Note: Refer to the *Drilling Diagram* section that is appropriate for your machine.

- 4 Drill the center hole using 1 inch / 25 mm drill bit suitable for drilling dashboard

- 5 Using an 11/64 inch / 4.4 mm drill bit, drill and deburr the remaining two holes.

11/64" ← ○

1" ← ○

11/64" ← ○

- 6 Route the keypad harness through the center hole.
- 7 Install the keypad assembly using the holes drilled as reference and secure it using the provided retaining fasteners.

Genie part numbers 1296895GT, 1300832GT, 1283019GT, 825357GT

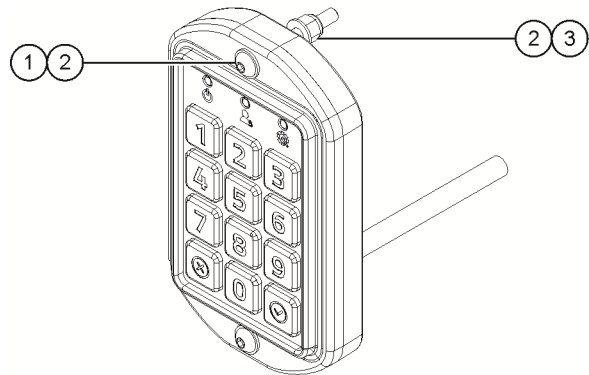

- 1 screw
- 2 flat washer
- 3 nylock nut

# Procedure

## GTH-2506, GTH-3007, GTH-5519 Models

- 8 Using a mild cleaning solvent, clean the surface and mount the adhesive wire clamps as necessary.

Genie part number 1273629GT

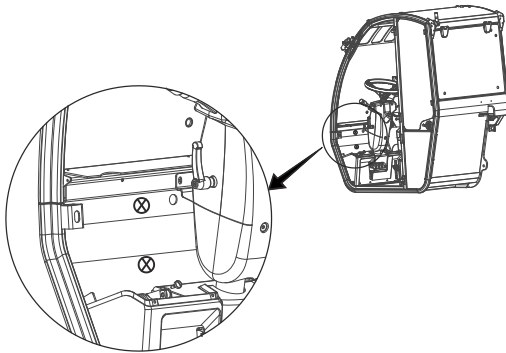

⊗ example of adhesive wire clamp locations

- 9 Open the brake oil access cover.

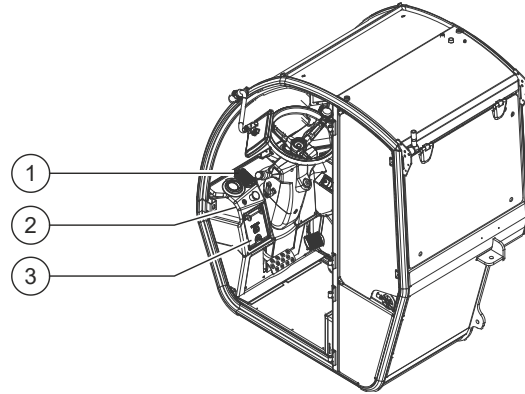

- 1 keypad
- 2 dashboard
- 3 break oil access cover

- 10 Locate and disconnect Genie Lift Connect telematics device from the gateway harness.

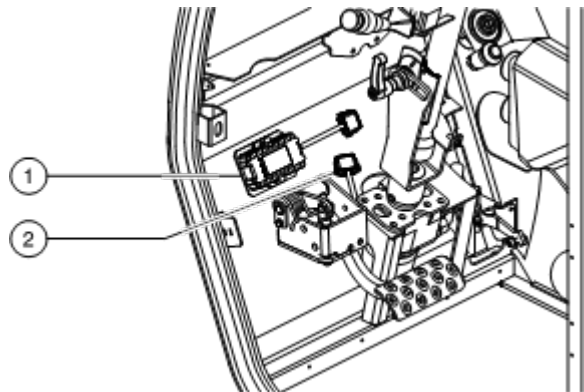

- 1 telematics module
- 2 gateway harness

## Procedure

- 11 Connect the access manager harness to the gateway harness.

Genie part number 1305083GT

Note: Harness connectors are keyed for proper installation.

### NOTICE

Component damage hazard. Improper connections will result in damage to the telematics module and it is not covered under warranty.

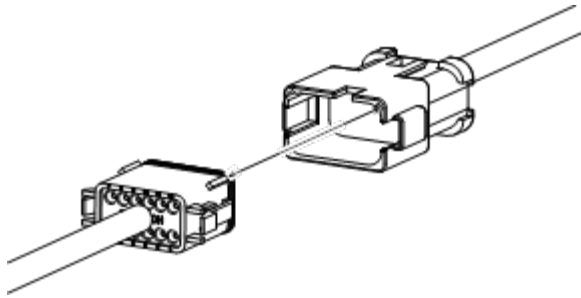

example of keyed harness connector

- 12 Connect the telematics device harness to the access manager harness.

- 13 Connect the 5 pin access manager keypad harness connector to the 5 pin connector of access manager harness.

Note: Secure the cable using the provided cable ties.

Genie part number 21121GT

- 14 Align white dots on the connector and push the plug together to connect the access manager harness to the keypad.



## Procedure

- 15 Tighten the connector to hand tight.
- 16 Close the cover (Oil Change).
- 17 Put the Access Manager user guide in the manual storage box located on the machine.  
Genie part number 1312869GT
- 18 Connect the black negative battery cable to the engine battery.

**⚠ WARNING**

Electrocution/burn hazard. Contact with electrically charged circuits could result in death or serious injury. Remove all rings, watches and other jewelry.

### GTH-636, GTH-844, GTH-1056 Models

- 19 Remove the retaining fasteners securing the left panel with the side console. Set the fasteners aside.

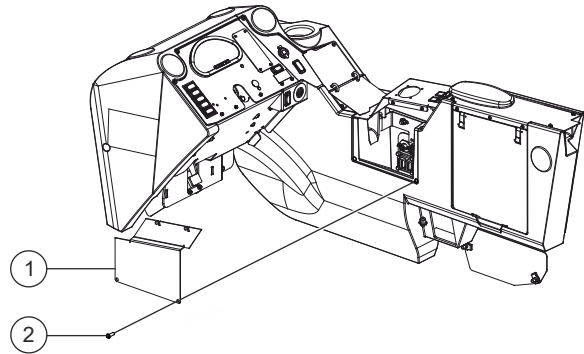

- 1 left side console
- 2 retaining fasteners



# Procedure

- 20 Remove the grommet from the left panel and set aside.
- 21 Remove the left panel from the side console and set aside.
- 22 Release the latch securing the right panel with the side console.

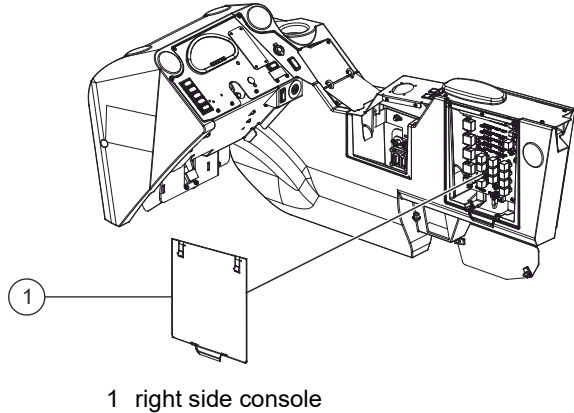

- 23 Remove the right panel from the side console and set aside.
- 24 Remove the retaining fasteners securing the 4-way joystick controller access cover. Set the access cover and fasteners aside.

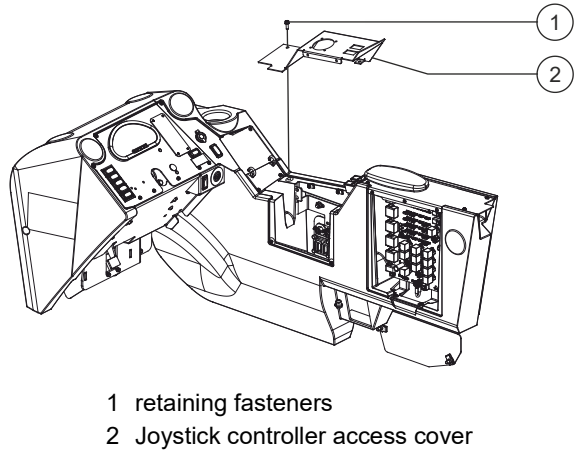

- 25 Remove the retaining fasteners securing the side console cover. Set the cover and fasteners aside.

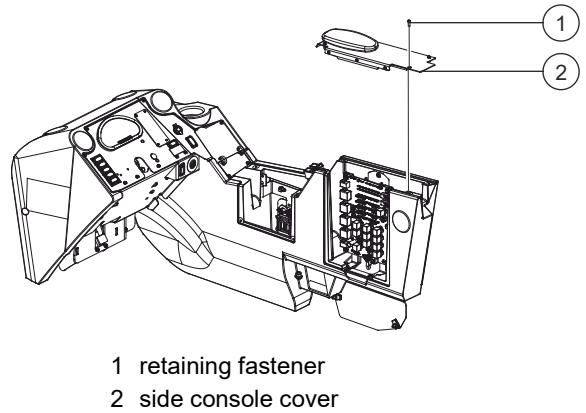

- 26 Remove the retaining fasteners securing the bottom cover with the dashboard. Set the bottom cover and fasteners aside.

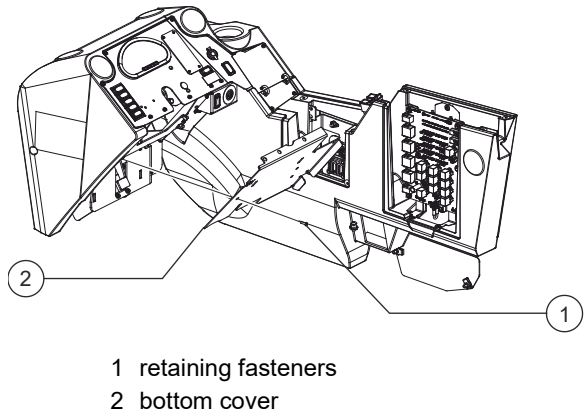

# Procedure

- 27 Locate and disconnect Genie Lift Connect telematics device from the gateway harness.

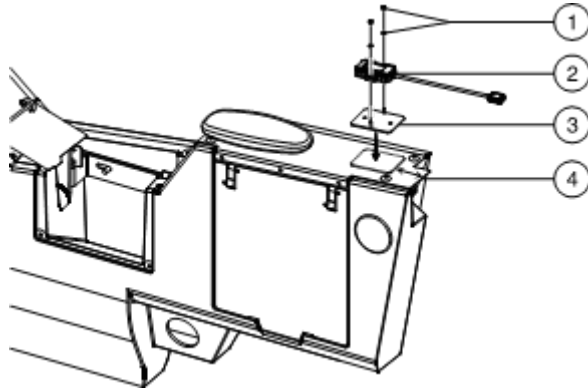

- 1 retaining fasteners
- 2 telematics module
- 3 telematics bracket
- 4 armrest mounting plate

- 28 Connect the access manager harness to the gateway harness.

Genie part number 1296897GT

Note: Harness connectors are keyed for proper installation.

**NOTICE** Component damage hazard. Improper connections will result in damage to the telematics module and it is not covered under warranty.

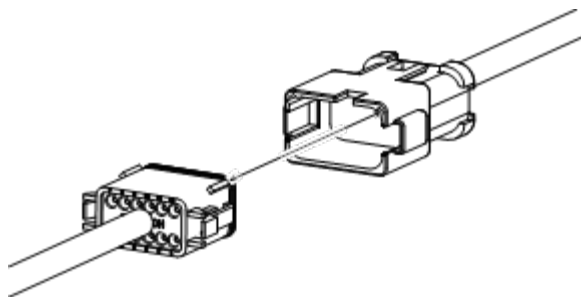

example of keyed harness connector

- 29 Connect the telematics device harness to the access manager harness.

- 30 Route the 5 pin connector of access manager harness towards dashboard along with other harness routed through the PCB assembly.

Note: Secure the cable using the provided cable ties.

Genie part number 21121GT

- 31 Connect the 5 pin access manager keypad harness connector to the 5 pin connector of access manager harness.

- 32 Align white dots on the connector and push the plug together to connect the access manager harness to the keypad.



# Procedure

- 33 Tighten the connector to hand tight.
- 34 Install and secure the bottom cover with the dashboard using retaining fasteners.
- 35 Install and secure the side console cover using the retaining fasteners.
- 36 Install and secure the 4-way joystick controller access cover using the retaining fasteners.
- 37 Install and secure the right panel with the side console using the latch.
- 38 Install grommet on the left panel and secure the panel with the side console using the retaining fasteners.
- 39 Put the Access Manager user guide in the manual storage box located on the machine.  
Genie part number 1312869GT
- 40 Connect the black negative battery cable to the engine battery.

**⚠ WARNING**

Electrocution/burn hazard. Contact with electrically charged circuits could result in death or serious injury. Remove all rings, watches and other jewelry.

## Relay Configuration

### GTH-2506, GTH-3007, GTH-5519 models

This procedure only applies to the following serial numbers listed below.

Model	from serial number
GTH-2506	from GTH2506B-211
GTH-3007	from GTH300716M-101
GTH-5519	from GTH55M-2375

- 1 Locate the telematics relay X103.
- 2 Remove the wire from relay socket X103, terminal 87A (NC) and install it into X103, terminal 87 (NO).

Note: Secure the cable using the provided cable ties.

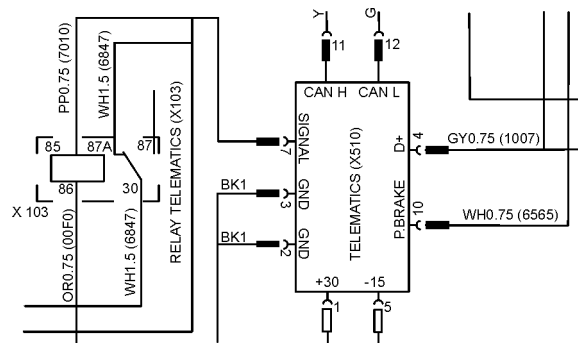

# Procedure

## GTH-636, GTH-844, GTH-1056 models

This procedure only applies to the following serial numbers listed below.

Model	from serial number
GTH-636	from GTH0615H-10001 to GTH0615H-10725 from GTH0615E-10000 to GTH0616E-10999 from GTH06E-11000
GTH-844	from GTH0813-16606 to GTH0816-2156 from GTH0816H-21547 to GTH0816H-21572 from GTH0816E-10000 to GTH0816E-10699 from GTH08E-10700
GTH-1056	from GTH1014-19341 to GTH1014-20404 from GTH1014E-10000 to GTH1016E-11799 from GTH10E-11800

- 1 Remove the PCB assembly access panel and set aside.

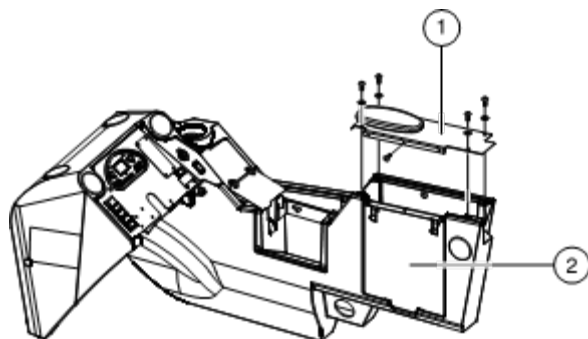

- 1 armrest assembly
- 2 PCB assembly access panel

- 2 Locate the relay CR18.
- 3 Remove the wire from relay socket CR18, terminal 87A (NC) and install it into the relay socket CR18, terminal 87 (NO).

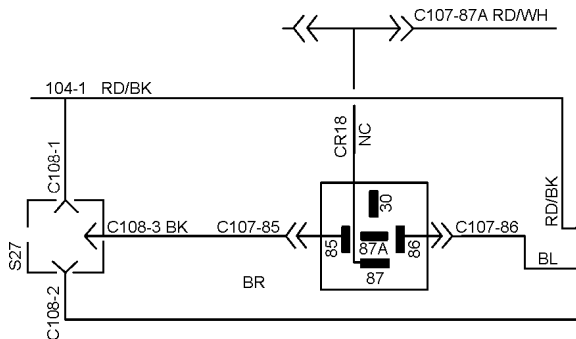

---

# Procedure

## Access Manager Activation

- 1 Navigate to the Options menu on the machine and verify Lift Connect is selected.
- 2 To complete activation of your Access Manager keypad please contact the Lift Connect team.

email to:

[AWP.LiftConnectSubscriptions@terex.com](mailto:AWP.LiftConnectSubscriptions@terex.com)

# Drilling Diagram

## GTH-2506, GTH-3007, GTH-5519 models

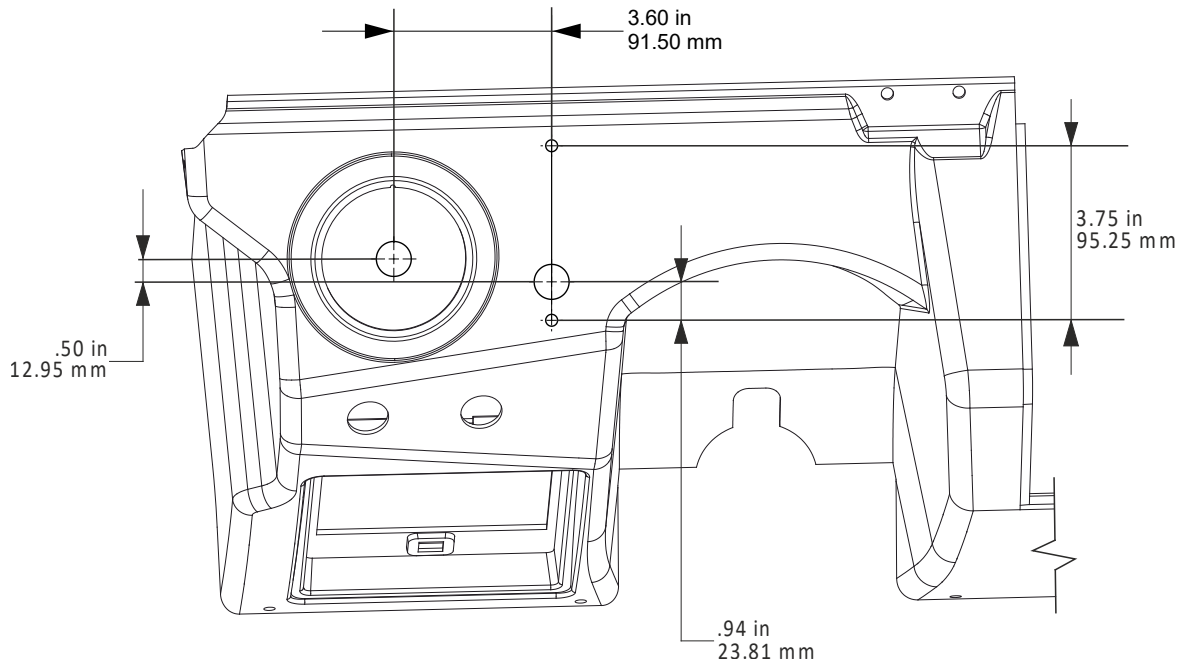

## GTH-636, GTH-844, GTH-1056 models

