

QUICK REFERENCE GUIDE:

GENIE BOOM TRANSPORT

This document applies to select Genie boom lifts equipped with load sense systems. This is a supplement, not a replacement, to the model specific Genie Operator's Manual and qualified training. Always refer to the model specific Genie Operator's Manual for full transport instructions prior to transporting a boom.

When possible, transport the boom with the platform floor horizontal to the transport trailer bed. Select booms and trailer combinations do not accommodate this orientation due to length, in which case the Operator's Manual must be followed for positioning the securing the platform.

Prior to transport, ensure the boom has current software, available at <http://firmware.genielift.com/>.

STEP 1: Securing to Truck or Trailer for Transit

- Always use the turntable rotation lock pin each time the machine is transported. (1) Turntable rotation lock pin.
- Turn the key switch to the off position and remove the key before transporting.
- Inspect the entire machine for loose or unsecured items.

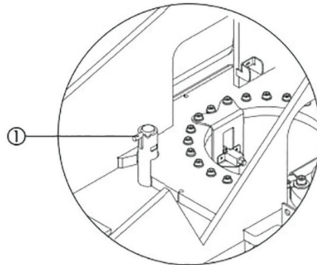

STEP 2: Securing the Platform

- Make sure the jib and platform are in the stowed position.
- Secure the platform with a nylon strap placed parallel to the strap guides. Do not use excessive downward force when securing the boom section.
- Support the platform support, opposite the nylon strap, with a force absorbing chalk such as foam, rubber, or wood.

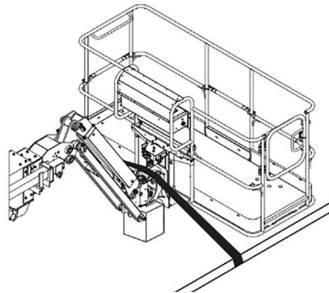

STEP 3: Securing the Chassis

- Use chains of ample load capacity.
- Use a minimum of 6 chains.
- Adjust the rigging to prevent damage to the chains.
- For diagram, refer to the Lifting Instructions in the Operator's Manual.

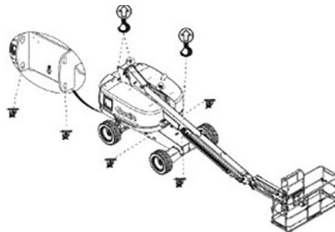

Additional Notice from the Genie Safe Use Plan Guidance

When a MEWP is being loaded or unloaded from a transport vehicle on a public road, the users and operators must ensure that appropriate measures are taken to protect everyone in or near the area.

These measures may include, but are not limited to:

- Warning cones or hazard tape
- Signs and signal personnel wearing reflective clothing
- Flag personnel to warn people and other vehicles of the presence vehicle

This is only an overview. Additional information can be found in the ANSI A92.24-2018 and CSA B354.7:17 Standards. We encourage you to purchase a copy of the standards and read them in their entirety prior to developing your Safe Use Plan.

- The ANSI A92.22-2018 Standards can be purchased at: <https://shop.saiaonline.org>
- The CSA B354.7:17 Standards can be purchased at: <https://store.csagroup.org>